

GEOGRAPHICAL LOCATION

MISSION

We are an _____ **from CIE Automotive dedicated to the**
_____ **for the** _____ .

We _____ **to worldwide known**
of the _____ .

We are committed to _____ **by the markets, and different**
stakeholders, _____ , **aligned with their**
expectations and needs, and _____ .

We _____ **for the** _____ **for the**
_____ **through the** _____ **of our team, in an undoubted**
with the surrounding _____ .

VISION

At CIE PLASFIL we are committed to maintain and reinforce our presence in the marketplace, in a , and manner, assuring the .

considered as within the industrial area, through the deliver and supply of products and services, with , and with .

ORGANIZATION CHART

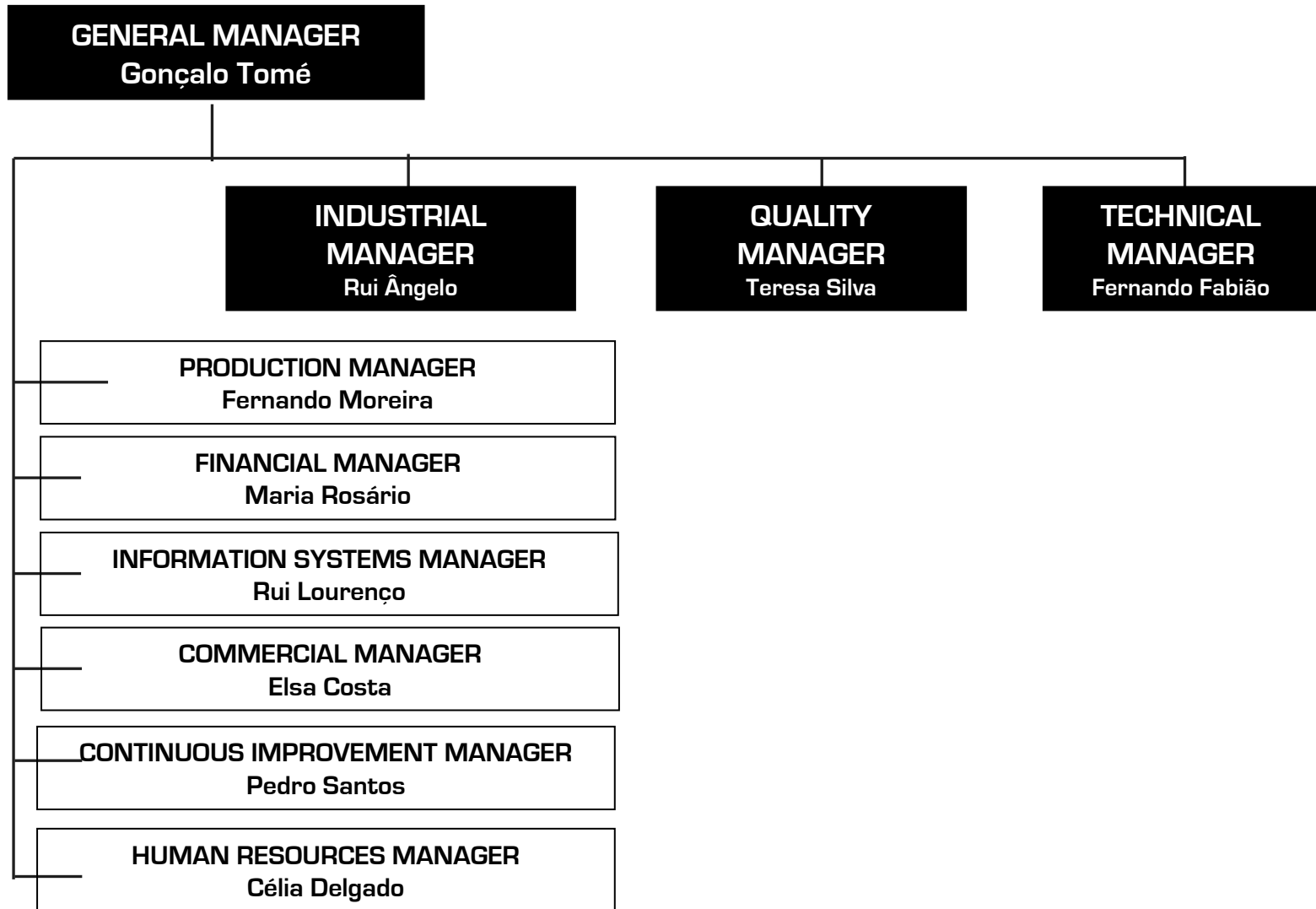

MAIN CUSTOMERS

AUTOMOTIVE - OEM's

VOLKSWAGEN AG

FORD MOTOR COMPANY

MITSUBISHI MOTORS

MAIN CUSTOMERS

AUTOMOTIVE - Tier 1's

- **LEAR Corporation**
- **FAURECIA Interior Systems**
- **YAZAKI Saltano**
- **VANPRO** (j.v. Johnson Controls – Faurecia)
- **DALPHIMETAL**
- **SAS Automotive Systems** (j.v. Siemens – Sommer Alibert)
- **VISTEON**
- **DURA**
- **HALLA CLIMATE**
- **G. ANTOLIN**

MAIN PRODUCTS

INTERIOR TRIM

Pillar Covers

MAIN PRODUCTS

INTERIOR TRIM

Aesthetic Painted Parts

MAIN PRODUCTS

INTERIOR TRIM

Cockpit Components

MAIN PRODUCTS

INTERIOR TRIM

Console Components

MAIN PRODUCTS

INTERIOR TRIM

Door Panels

MAIN PRODUCTS

EXTERIOR / HARD TRIM

Roof Racks

MAIN PRODUCTS

SEATS

Rear Covers and Components

MAIN PRODUCTS

SET ELECTRIC

AirBag Covers

MAIN PRODUCTS

SET ELECTRIC

Cable Channels

MAIN PRODUCTS

SET ELECTRIC

Junction Boxes

MAIN PRODUCTS

SET ELECTRIC

Covers & Housings

MAIN PRODUCTS

SET ELECTRIC

Switch Carriers

MAIN PRODUCTS

Air Ducts

QUALITY MANAGEMENT

VDA 6.1

ISO 9001

QS 9000

ISO TS 16949: 1999

21st Sept 2001

ISO TS 16949: 2002

First 14th June 2003 / Actual valid till 28th May 2009

**EFQM - European Foundation
Quality Management**

Self-Evaluation Level 1st half of 2006

VDA 6.3 – 93% A Supplier

29th April 2005

ENVIRONMENT MANAGEMENT

ISO 14001: 2004

HEALTHY & SAFETY MANAGEMENT

OHSAS 18001: 1999

PRODUCTION RESOURCES

PLASTIC INJECTION

41 Injectors (from 40 up to 1375 Tons)

WELDING

Ultrasonic

Mirror welding

GAS INJECTION & BI-MATERIAL INJECTION

INMOLD & HOT-STAMPING (under industrialization)

SURFACE MARKING

Laser

Tampo Printing

SURFACE FINISHING

Sub-Contracted Painting

Sub-Contracted Chromium Coating

Press (ton) Qty

40 1

50 3

60 2

80 2

100 2

145 3

150 3

200 1

210 3

225 2

250 1

300 2

325 4

400 2

420DF 3

420 1

600 1

650 2

800 2

1375 1

WELDING PROCESSES

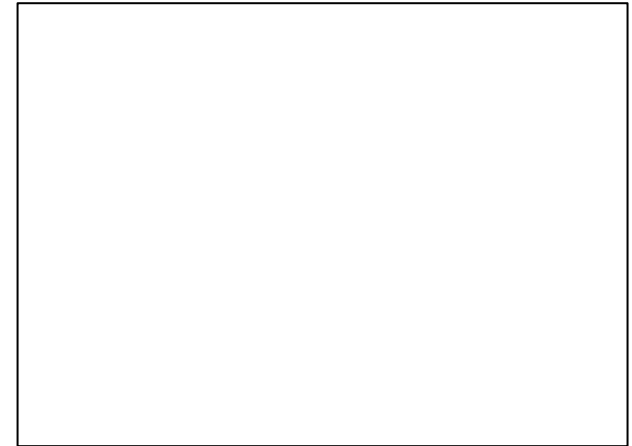

HOT PLATE / MIRROR

WELDING PROCESSES

ULTRASONIC

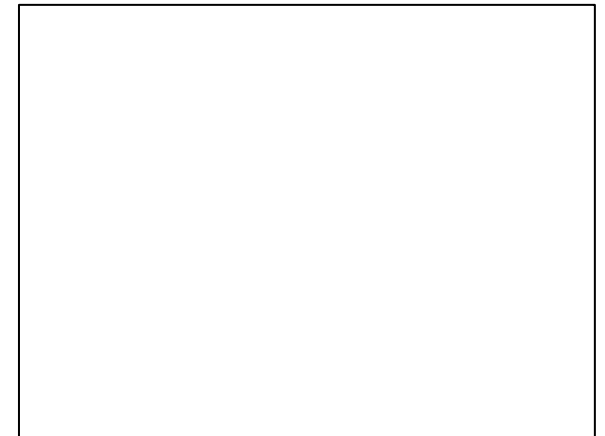
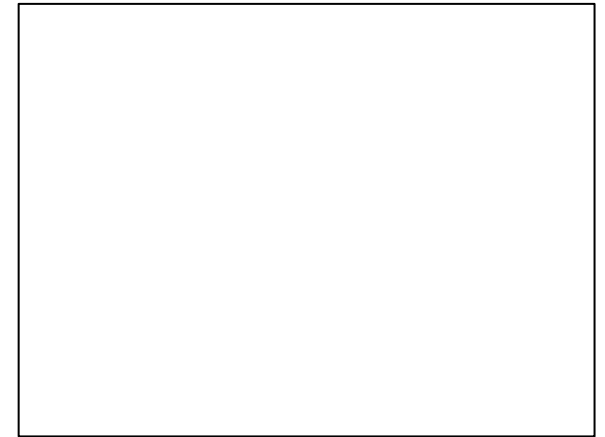

CONTINUOUS IMPROVEMENT

OPERACIONAL EXCELLENCE PROGRAM

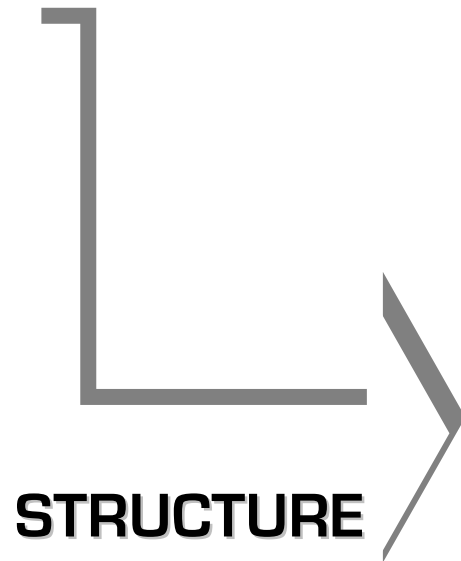

CONTINUOUS IMPROVEMENT

PROJECT MANAGEMENT

KAIZEN GROUPS

5S's METHODOLOGY

GEMBA LEADERSHIP

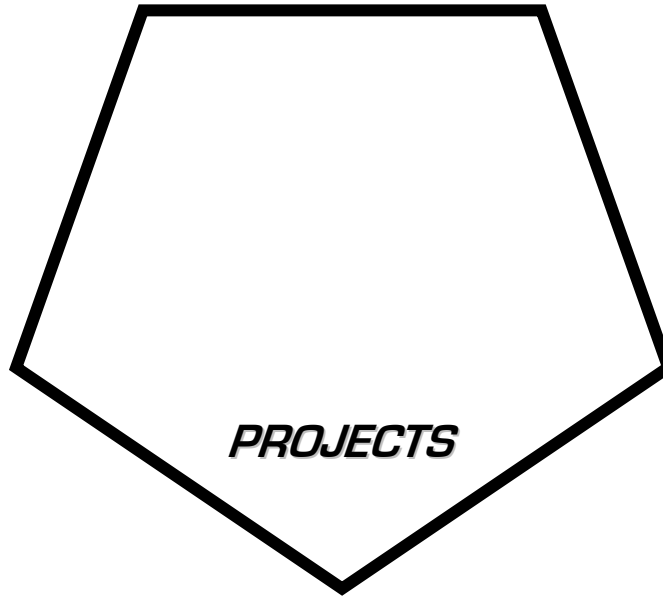

TRAINING

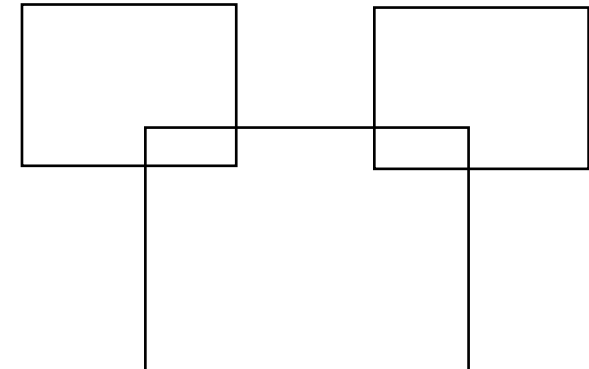

QUALITY CONTROL

METROLOGY

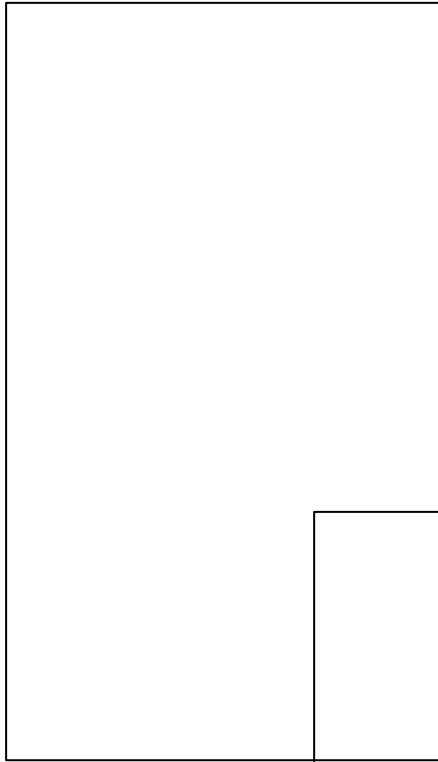

**Polishing and
Profile Projection**

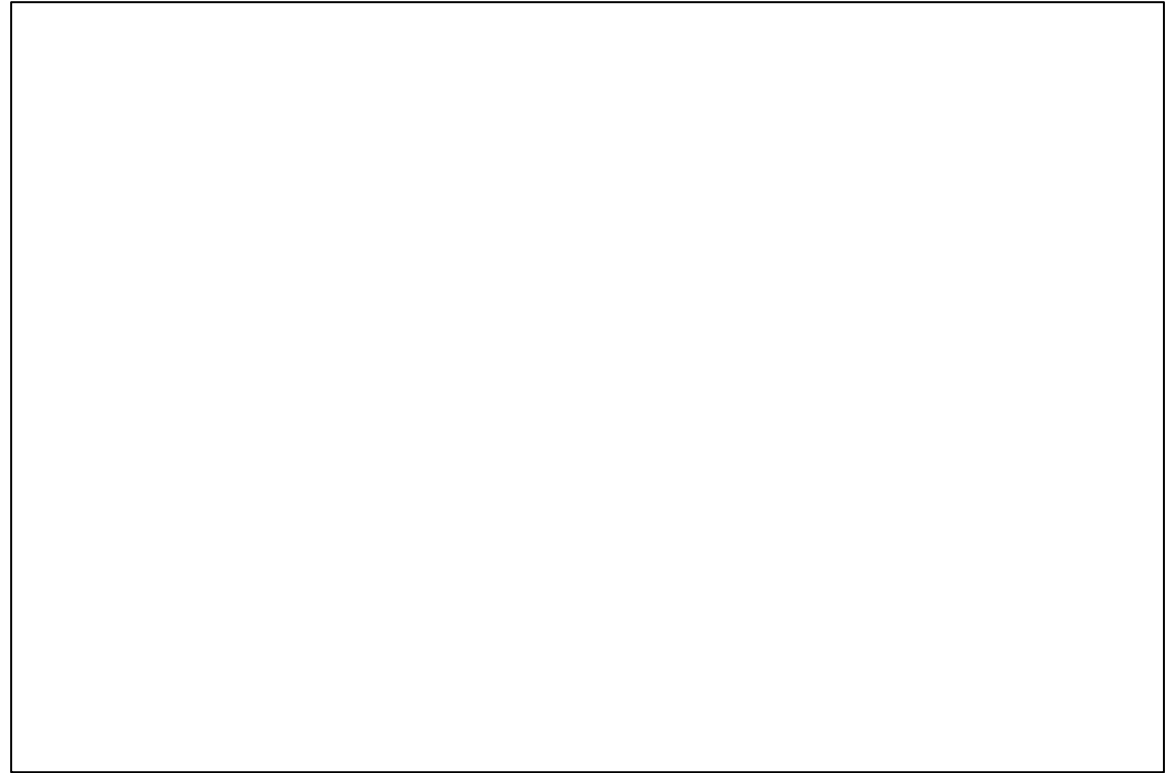
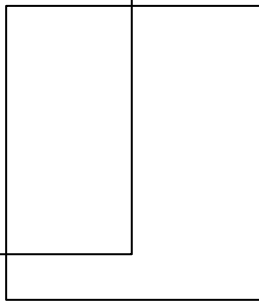

3 D Measuring Machine - ZEISS



Precise Callipers, Micrometers, ...

QUALITY CONTROL

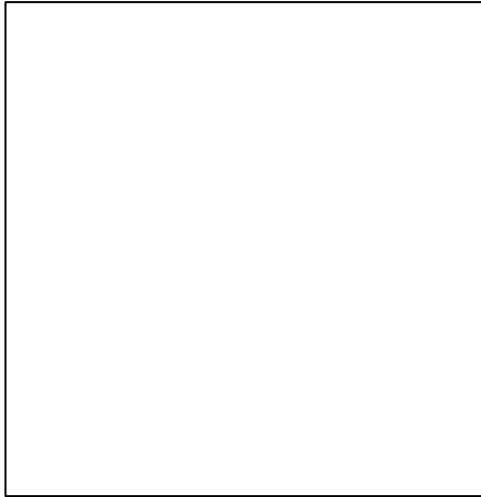

IZOD/CHARPY Impact

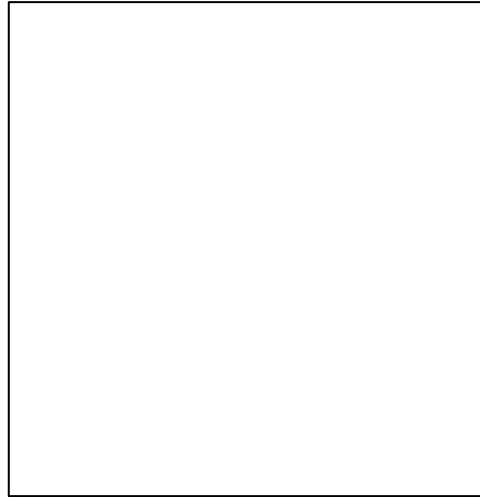

Flammability Residue



MFI - Fluidity Index

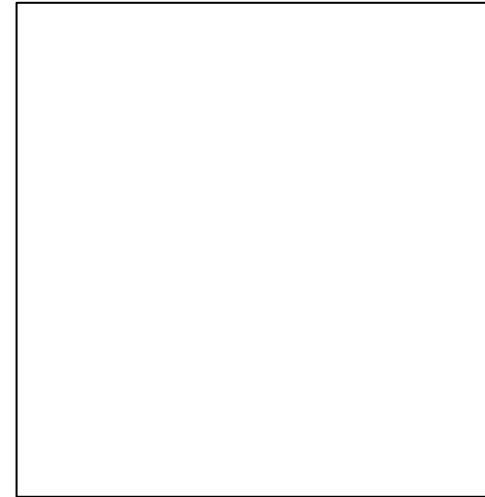

Climatic Chamber



HDT / VICAT



Colour / Gloss Measur.



Strength/Compression

Light Chamber

RESEARCH & DEVELOPMENT – R&D

CAD - DESIGN RESOURCES

3 x CATIA V4 + 2 x CATIA V5

2 x Pro/Engineer 2000i2

2 x I-DEAS 10NX

1 x UNIGRAPHICS NX 3/4

Mechanical Desktop

CAE - ANALYSIS RESOURCES

Moldflow 4.1 (Rheological)

Pro Mechanica 2000i2 (Structural)

SIMDesigner (Structural)

3D CS (Tolerances)

RESEARCH & DEVELOPMENT - R&D

CAD - CATIA

CAD - I.DEAS

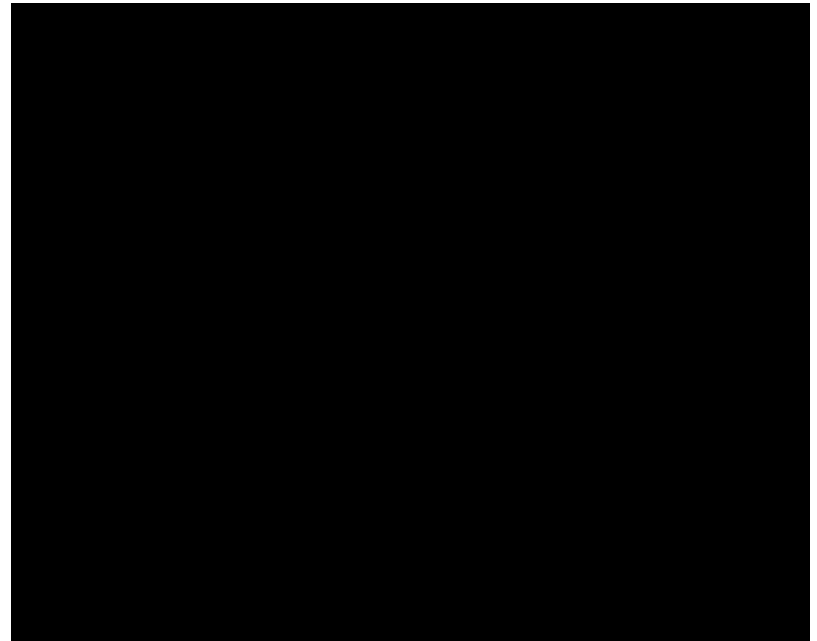

RESEARCH & DEVELOPMENT – R&D

CAD - UNIGRAPHICS

CAD - PRO ENGINEER

RESEARCH & DEVELOPMENT - R&D

CAE - PRO MECHANICA

CAE - MOLDFLOW